

Amenities & Property Details

AMENITIES

Smart Televisions

High Speed Internet

Outdoor Patio

Large Fenced Yard

Dedicated Office Space

Gas Grill

Outdoor Fire Pit

Sunset Views of Green Bay

2-Car Garage

Artwork from Local Artists

Exercise Bike

PROPERTY DETAILS

Sunset Ridge

Sunset Ridge is a great new high-end 2-bedroom dog-friendly rental with a fenced yard and fantastic sunsets over Green Bay. We offer 7-day minimum rentals at very reasonable prices. Perfectly located on the bluff above Bay Shore Drive, just north of Sturgeon Bay, our home is only 15 minutes south of Egg Harbor and less than 25 minutes from Baileys Harbor and Fish Creek. Great hiking at Whitefish Dunes State Park is only 15 minutes away. More great hikes at the Ice Age trail in Potawatomi State Park and Peninsula State Park are also nearby. Many golf courses, great restaurants, and iconic lighthouses are within a short drive. The Green Bay airport and the world-famous Lambeau Field are only an hour away. But most of all, our house offers the best sunsets Door County has to offer, night after night. Questions? Call us at 757-512-0222 or email bobs7272@gmail.com.

ARE YOU ON VACATION? Enjoy the outdoors in and around Door County all day, then come back to enjoy all the comfortable amenities, including fire pit, gas grill, board games, smart TVs, air conditioning, and a fully equipped kitchen for preparing meals. A dishwasher and washer and dryer make life on vacation a little easier.

DO YOU LOVE TO BE ACTIVE OUTDOORS? Door County has more miles of shoreline than any other county in America. There are dozens of beaches and five of Wisconsin's expansive and beautifully maintained state parks where you can swim, hike, bike, fish, or participate in a variety of water sports and other fun outdoor activities. The roads throughout Door County are great for bicycle rides. If your stay coincides with cherry picking (mid-July) or apple picking (fall), you will be in for a treat! Golf is 15 minutes away at The Orchards in Egg Harbor or Maxwellton Braes in Baileys Harbor. In the winter months the possibilities are many: Snowshoeing, cross country skiing, snowmobiling, ice fishing and fat tire biking.

ARE YOU A REMOTE WORKER? We have a dedicated office space with WiFi, desk, comfortable office chair, and the best views!

DO YOU LOVE DOGS? We do too! We are pet friendly and welcome two well-behaved dogs for a small pet fee. The fenced in yard and nearby hiking trails ensure that your pup will get plenty of exercise and fresh air!

Floor Plan

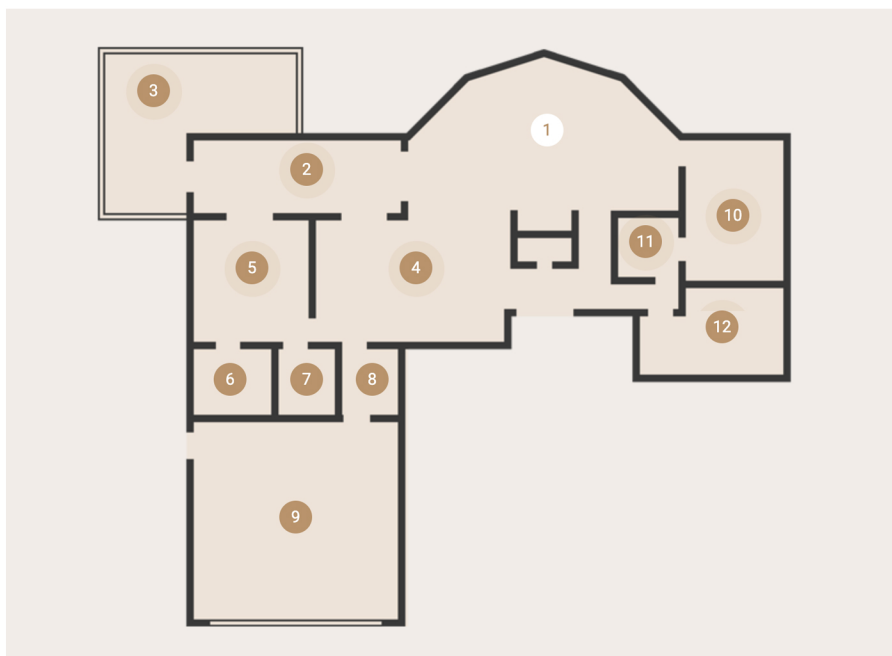

- 1 GREAT ROOM ^
Open concept living area with spectacular views of Green Bay
- 2 SUNROOM v
- 3 DECK v
- 4 KITCHEN & DINING AREA v
- 5 MASTER BEDROOM v
- 6 MASTER BATH v
- 7 WALK-IN CLOSET v
- 8 LAUNDRY v
- 9 GARAGE v
- 10 BEDROOM v
- 11 BATHROOM v
- 12 OFFICE v